



# GLEN EIRA HISTORICAL SOCIETY NEWSLETTER

## Carre and Riddell – the origin of two Elsternwick street names

John Carre Riddell (1809-1879) emigrated from Scotland in 1839. He first went to the Western District before buying, in 1840, the stock and depasturing licence of the Mount Macedon run, north of Melbourne.

In 1860 – 1877 he was a member of the Victorian Legislative Assembly. Riddell was a liberal, favouring compulsory, secular education and the reduction of state aid to religion. He was described by *The Argus* as being 'distinguished by gentleman like bearing and high character rather than political activity or demonstrativeness'. He was an early member and President in 1852 of the Melbourne Club.

Riddell lived at his home Cavers<sup>1</sup> Carre in Elsternwick from 1866 until his death and is buried in Gisborne in the family cemetery. The town of Riddells Creek and the streets Carre and Riddell in Elsternwick bear his name.



Cavers Carre, the Riddell's residence at Elsternwick, undated (Riddell Papers, La Trobe Library and published in *Australians* 1888, Fairfax, Syme & Weldon, 1987)

<sup>1</sup> Endnote – Cavers is a parish in the Scottish borders area; meaning enclosure (Wikipedia)

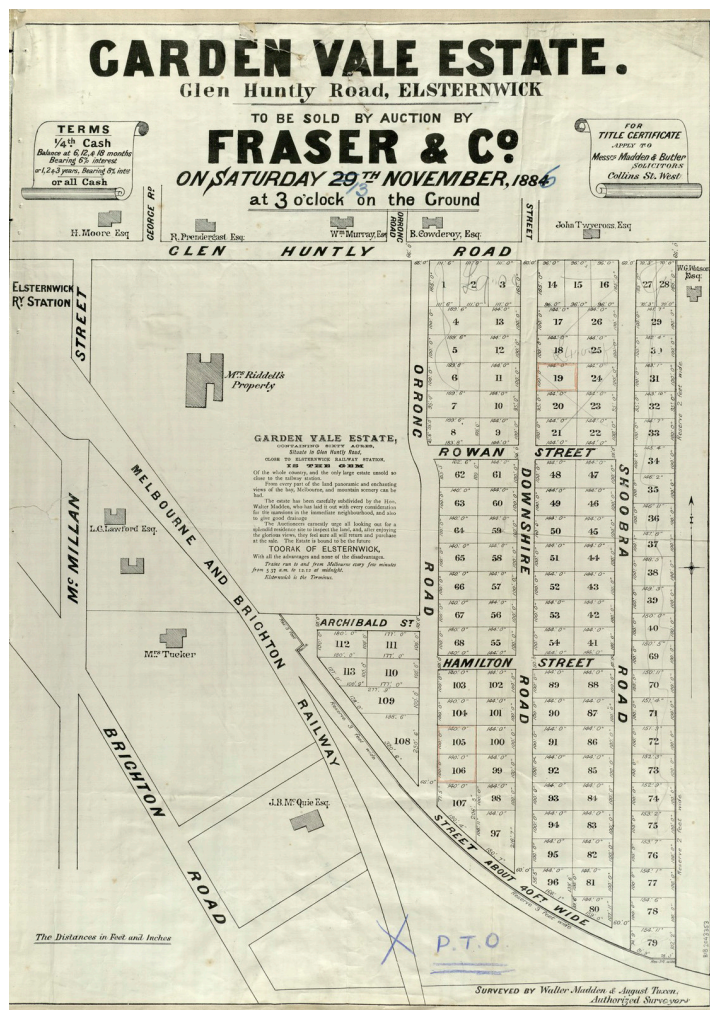

Map of Garden Vale Estate 1886 showing Mrs Riddell's property, Cavers Carre, (Courtesy L Rowbell and <http://nla.gov.au/nla.obj-231678760>)

## A golfing family at Cavers Carre

In the preface to his book, *Evolution of Golf in Victoria*, Gervase Carre Riddell, the grandson of John Carre Riddell, wrote of the years he spent living in Elsternwick.

*I was born at Brighton, a suburb of Melbourne, and when my mother died in 1898 when I was seven*

## Contents

Carre and Riddell – the origin of two Elsternwick street names	1
From the President	2
Designing, Creating and Curating Exhibitions	4
Artefacts Management	7
A link to the history of North Road Medical, featured in our November 2023 newsletter.	8
Heatherbrae, a Caulfield mansion - November 2023 Speaker Series Report	9
Heritage Matters	10
Events and Exhibitions	11

## From the President

GEHS re-opened on Tuesday 6<sup>th</sup> February and it was wonderful to welcome back our volunteers who were keen to turn their minds again to local history. Our first Speaker Series on 27<sup>th</sup> March will be a show and tell, *Eyes on our Collection*, and will highlight some interesting items from our collection. In May we will hear from Nathan Hobby via Zoom from Western Australia about his biography of the author Katharine Susannah Prichard (1883 – 1969) who lived her early years in Caulfield. Further details about these events can be found on page 11 of this newsletter.

Enquiries during January kept us busy, a couple from international visitors to Melbourne. The grandson of a Dr HO Cowen contacted us about Matlock Mansions on Dandenong Road where his grandfather had lived in the 1930-40s. We were able to provide a photograph of the 1880s building, demolished in the 1960s, but unfortunately had no information on the family.

We also heard from an interstate reader of our newsletter in response to the article in our March 2023 newsletter on the Shelton family of 494 Glen

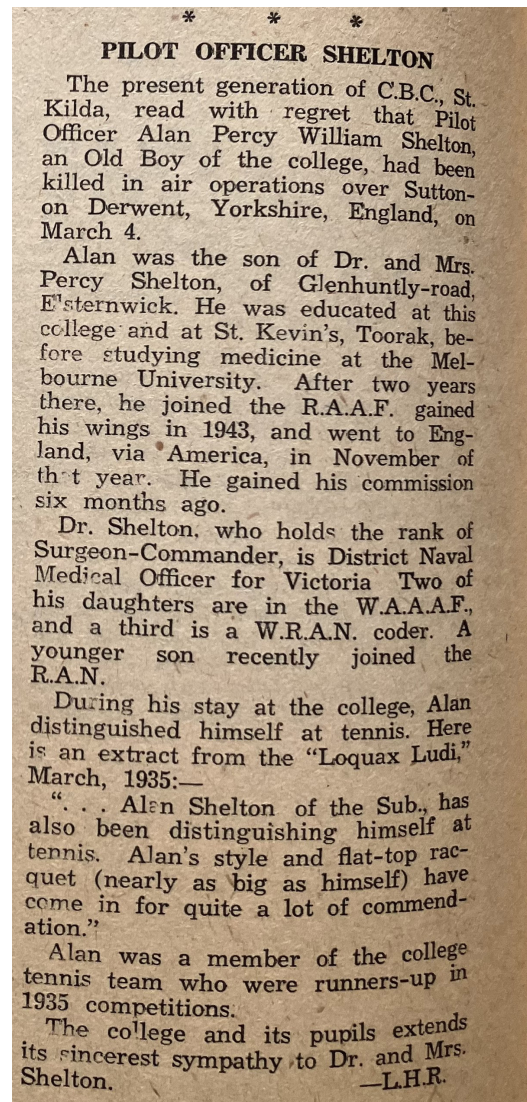

Huntly Rd, Elsternwick. Reader Frank had attended CBC St Kilda in the 1970s and came across an item (see above) in the school's newsletter of April 1945 remembering past student Alan Shelton of Elsternwick. Pilot Officer Shelton was killed in England while serving in the RAAF during WWII. Thank you to Frank for sharing this information which will be added to our files.

In this issue we revisit golf with an excerpt from a rare book, *Evolution of Golf in Victoria* by Gervase Carre Riddell, a name which will be recognised by those familiar with the streets of Elsternwick. We hope you enjoy reading this and other articles in our first newsletter for 2024.

**Barbara Hoad,**  
**GEHS President**





years old, my father took us, his four children, to live at Elsternwick, about three miles away, in my late grandfather's house, Cavers Carre, an old two-storey building in the midst of 17 acres of land.

This house was occupied by my uncle W. J. C. [Walter John Carre] Riddell, a maiden aunt who acted as our mother, and another aunt with a son and daughter, who were adults, all five of whom were members or associate members of the Royal Melbourne Golf Club. You could almost say that I lived in an atmosphere of golf and often listened keenly to many discussions on the game.

My uncle won the Victorian Amateur Golf Championship that year, and on two subsequent occasions, and was Captain of the State team till 1914. When the Victorian Golf Association was formed in 1902, he was elected Vice President and the next year President, a position he held on and off until his death in 1930.

Like most boys, I was keen on cricket, football and running but I strained my heart running in 1903 and was stopped from taking violent exercise for two or three years and my uncle suggested golf. He gave me a couple of clubs and a batch of gutty golf balls. (He had changed to the Haskell, the first of the rubber ball 'just invented'.) I laid out my first golf course of nine holes on the 17 acres around the house.

I got a very good start in golf here as my uncle used to occasionally practise as well and also from A. R. Lempriere who lived just opposite and used to practise constantly in the late afternoons. He was second in the Australian Open in 1913 to the winner Ivo Whitton and reversed the position a few days later by beating Whitton in the final of the Amateur.

I played my first round of golf at Royal Melbourne with my aunt in 1905 and joined my first golf club in 1909. (The Elsternwick Golf Club now known as the Kingston Heath Golf Club at Cheltenham). I won the club championship there in 1911 and again the next year.

My uncle was chairman of the Melbourne and Metropolitan Board of Works so he was a very busy man and since there were no golf architects in those days, golfers would write to him as President of the Victorian Golf Association wanting his opinion on how to redesign certain holes on their course.



W. J. C. Riddell practising his technique at Royal Melbourne  
(*The Australasian* 1901, courtesy Leon Rowbell)

He might show me the letter and suggest that I redesign it and when I showed him my plan we would discuss it, possibly make amendments and then answer their letter. By this method I saved him a certain amount of thought and learnt a lot myself.

I have been constantly connected with golf from the early days of my life, the only breaks were during the First and Second World Wars.

During the first portion of my life all my golf was in Melbourne up till the start of the 1914 war, and after I returned from the war, I bought an irrigation farm of 580 acres in the Swan Hill area and lived in this district ever since where my chief interest has been golf. [End of preface]

**Gervase Carre Riddell** was born in 1891, the year Melbourne Golf Club (Royal Melbourne Golf Club from 1895) was established. The RM golf course was originally in the Malvern/East Caulfield area with a clubhouse in Turner Street, Malvern. In 1901 it shifted to its present site in Cheltenham Road, Black Rock. In 1892 the club brought in Associate Membership for women. This might help explain

continued on page 4

why some of the female residents of Cavers Carre were keen golfers.

Close by the Riddell family home of Cavers Carre, was the forerunner to the Kingston Heath Golf Club, the Elsternwick Golf Club, which opened in 1909. By 1925 the club had moved away from the urban sprawl to the current site at Cheltenham and was renamed Kingston Heath Golf Club. Gervase won two Club Championships at Elsternwick when, it is calculated, he was around 21 years of age. Of course, he may have been on a favourable handicap at that tender age! Golfing experts tend to judge Royal Melbourne and Kingston Heath as the two pre-eminent golf courses in Melbourne.

With its nine-hole golf course, Cavers Carre provided a key domestic environment that enhanced the development of golf in Melbourne at the turn of the century. We surmise that golf would have been a major topic of conversation around the dining table, especially as the ladies were also involved. Gervase's heart condition prevented

him from taking up cricket and football but the environment he lived in at Cavers Carre would have been a powerful magnet to move him towards golf as his preferred sport.

Thanks to GEHS member and golfing historian, Leon Rowbell, for providing us with a copy of Gervase's rare book on the early days of golf in Victoria, the image of WJC Riddell, and the Garden Vale Estate map showing the Riddell property. Leon's information has given us further insights to life in Elsternwick in the early 20<sup>th</sup> century and provenance of the street names Carre and Riddell.

**Joy Mawbey, Neville Daynes (GEHS Volunteers/ Members)**

### Bibliography

*Australian Dictionary of Biography* <https://adb.anu.edu.au/biography/riddell-john-carre-4476>

*Evolution of Golf in Victoria*, Gervase Carre Riddell, self-published 1976, Swan Hill, Victoria

*Australians 1888*, Fairfax, Syme & Weldon, published 1987

Royal Melbourne Golf Club website -<https://www.royalmelbourne.com.au/history/>

## Designing, Creating and Curating Exhibitions

Since early childhood I have always been interested in all things creative: in art, design and form so it was no surprise that I commenced my working life initially at Myer Melbourne emporium in visual merchandising. This involved creating and installing interior displays to entice and capture the customers' attention. While with Myer I completed a three year in-house course on the design, execution and relevance of interior and window displays including one component of the course covering the layout and design of exhibitions for both in-store and other venues. During this time I received four awards for achievement from the "Australian National Display Association".

Having worked at Myer in the city, Chadstone and Eastland stores I then worked at the Buckley & Nunn department store in the city, first in a senior position then as Display Manager. It was while working there that I developed a finer appreciation of all things historic as this store was like a time capsule. The architecture and interior decoration

of the store was fundamentally the same as when it first opened in 1851 except for the addition of escalators and newer elevators.

I have been responsible for many exhibitions during my career but none more exciting or prestigious than when, in 1980, Buckley's (as it was known) was asked if, in conjunction with the Wedgewood Company, we would participate in the centenary of the Exhibition Buildings (1880-1980) with an exhibit presenting Wedgewood china and ceramics covering the 100 year period. I was asked to create it. The exhibit was an overwhelming success and a highlight of my career. I was also privileged to meet and shake the hand of Princess Alexandra (the late Queen's cousin) and her husband Sir Angus Ogilvy who officially opened the exhibition and renamed the Exhibition Buildings the "Royal Exhibition Buildings". The exhibition ran from 24th September to 5th October 1980.

Soon after Buckley's was sold and taken over by David Jones Australia Ltd. where I was promoted to Advertising and Promotions Manager for the Melbourne store and later to the same position





at Georges Australia Ltd. in Collins Street where I supervised many interesting and varied promotional activities. But it was while I was at David Jones that I was really able to explore my passion for history as I was tasked with creating and implementing an archive of the history of Buckley & Nunn and David Jones Melbourne. I found this a fascinating task and really enjoyed this aspect of my role. However, I subsequently moved into the areas of sales and marketing in two very different companies. Needless to say, I have never lost my interest in history and in creating displays and exhibitions. In my retirement I began volunteering at Glen Eira Historical Society and again had the opportunity to be involved in designing, creating and curating exhibitions.

Presenting an exhibition in an historical context is quite different from a display/exhibition in a retail environment where it is a "silent salesman" to entice customers to buy the product in the store or window display. At an historical society, an exhibition's role is to evoke an era of the past in order to inform and capture the interest of the viewer and transport them to a new understanding of the subject on show.

It was at GEHS that I first suggested that we put

Richard with his Wedgwood display, Buckley's department store, Melbourne 1980 (Photo courtesy Richard Darke)

on an exhibition in one of our rooms for History Week 2011 as a publicity exercise to promote our historical society to a wider audience. It was decided to exhibit items from our collection, mainly artefacts but also some photos, maps and files of wider interest. It was only open on Tuesday, Friday and Sunday of that week as it took up valuable work space used by our volunteers. The display proved very successful.

In 2014 GEHS undertook its most extensive exhibition which was to commemorate 100 years since the outbreak of World War 1. It was entitled "On the Homefront: World War One in Caulfield and Beyond". This proved to be a most popular exhibit in our rooms for History Week that October. It then travelled to Caulfield RSL for Remembrance Day in November and then to Prahran Mechanics Institute during April to May of 2015.

On Sunday 18th October 2015 an Open Day at the Brighton General cemetery was held to celebrate 160 years since the first burial there. I was asked to co-ordinate a display at "The Lodge" at the cemetery in which Brighton Historical Society, Box





WWI exhibition at Prahran Mechanics Institute, 2015 (GEHS Collection)

Cottage Museum, Gardenvale Primary School, GEHS and the Brighton Cemeterians participated. This included various cemetery-related displays over several rooms and a detailed timeline of the cemetery's history lining the walls of the hallway. It was an immense amount of work for all involved but was an extremely well-supported event with very eye-catching displays.

GEHS displays have gone from strength to strength with exhibitions now executed at the Glen Eira City Council Gallery in Gallery Two. In 2021 in "Sights Unseen", on show were items from our collection that had never been shown before. In 2023 "Musical Notes from Glen Eira" was an exhibition of musicians, bands, instruments and musical paraphernalia from Glen Eira's past. As well as larger exhibitions we still have small, temporary displays at the GEHS rooms showcasing the many and varied items and subjects in our large

collection, some still to be tagged and catalogued and available for future display.

**Richard Darke, GEHS Member and Volunteer**



GEHS Sights Unseen exhibition 2021 (Photo Richard Darke)



# Artefacts Management

The Society has a significant collection of artefacts including certificates, photographs, trophies, memorabilia, clothes and accessories, plaques, honour boards, flags, ceramics and old bottles.

Most of the items have been donated over the years by persons wishing to have the item preserved for future generations. They possibly came from a deceased estate, or from de-cluttering, or from someone cleaning out a shed or garage.

As donations are received, they are added to a list containing the donor's name and with a brief description of the donated item. Later, each item is described in more detail and catalogued in our Artefacts Register, then it is carefully stored under archival conditions.

An interesting artefact is a cloth-bound ledger from Looker & Co, and Cranny, Sambell & Co who

were Estate Agents with offices in Railway Avenue, Caulfield. A sample page shown below has extracts from Contracts of Sale in the 1910s, and gives the property address, sale price, vendor and purchaser names, Lot No, Volume & Folio. It includes properties sold in Caulfield, Carnegie, Elsternwick and Malvern.

## Colin Kirkham GEHS Volunteer/Member

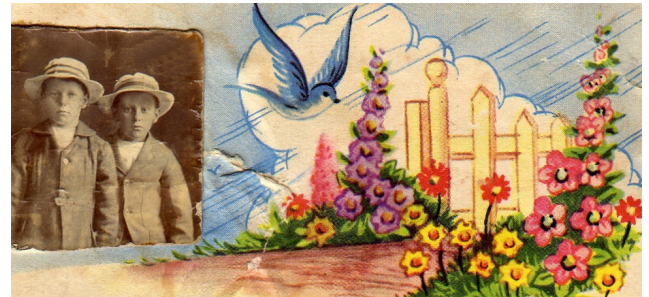

One of the many family photographs in our collection. Bill Carroll, right, in school uniform, Glen Huntly, 1919 (GEHS Collection, donated by the Carroll family)

No. in	Street	Side	19	Folio	
OWNER	ADDRESS	VENDOR	ADDRESS	PURCHASER.	REMARKS
18.7.16	Ardrie Road, East Malvern	£525.	Wall Mr. E.C.	Cartwright Mr. O.F.	Part of Lot 48 1/s. 4748 3965 792529
12.9.13	Balsize Av. Carnegie	£500	Tollatson Mrs. A.	Powar Mrs. A. M.	Lot 54 2293 458579
7.11.17	Balaclava Rd. Caulfield	£680	Williams Mrs. M.	Armstrong Mr. R.A.	13135 622933
11.1.16	Belson Street, E. Malvern.	£860	Warner Miss I.M.	Lynne Mrs. E. G.	Lot 85 3809 761715
27.8.15	Coppin Street, E. Malvern.	£625	Williams Mrs. M.	Godfrey Mrs. A.	2/s. 740 3541 708028
12.2.14	Douglas Street, E. Malvern	£1130	Warner Miss I.M.	Matthiessen Mr. E.	Lots 147, 148 Commencing 551' N. from Waverley Rd. West side.
14.7.17	Glenhuntly Rd. Glenhuntly	£300	Sambell Mr. F.O.	Jones Mr. G.H.	Lot 7 & part 6 2273 454440
31.7.12	Leamington Cr. Caulfield	£97/3/9	Rowbury Mr. T.G.	Mewett Mrs. M.A.	Lot 4 3256 651053
30.6.15	Lorne St. Caulfield	£400	Williams Mrs. M.	Evans Mr. G.P.	C/P. 48 3787 757398
22.8.14	Moama Rd. E. Malvern	£540	Wright Mrs. M.E.	McLennan Miss A.	Lot 52 4748 758673
12.5.15	Moama Rd. S/E cor. Warley Rd.	£475	Scarsborough Mr. J.	Oliver Mr. J.	Part of 27, 28 3674 734783
30.11.15	Moama Rd. E. Malvern.	£480	McLennan Miss A.	Jones Mrs. E.A.	P/S. 4784 3794 758673
10.1.16	Manning Rd. S.E. cor. Tennyson	£520	Rees Mr. W.	Layton Mrs. A.	C/P. 138 2073 414426
7.12.13	Mimosa Rd. Carnegie	£682/10	Retallack Mr. J.	Moncrieff Mr. E.P.	Lot 36 1872 374365
13.3.17	Nott St. E. Malvern	£875	Warner Miss I.M.	Brown Mrs. T. M.	Lot 12 13941 788062
9.11.17	Princes Av. Caulfield	£360	Pearson Mrs. L.	Stephens Mr. A.	Lot 11 4314 F/S.
26.6.13	Rugby Road, Oakleigh	£132	Swyer Miss E.S.	Hatton Mr. J.	Lots 93, 94 1362 388039
28.9.16	Repton Rd. E. Malvern	£420	Rynhart Mrs. E.M.	Rundell Mrs. N. R.	C/P. 142 3800 759943
23.2.16	Tooronga Rd. S.E. cor Coppin St.	£850	Outhwaite Mr. A.G.	Pascoe Mr. N.J. & M.	3510 701825
6.9.18	1 Ash Grove, E. Malvern	£283/6/8	Rodda Mrs. M.	McGregor Mrs. K.	Lot 150 4073 814571
31.7.18	1 Bates St. E. Malvern	£1850	Tooker Mrs. E.J.	Bowman Mr. A.J.	Part 149 3163 632483
8.10.18	Erica Av. E. Malvern.	£1050	Williams Mr. F.J.	Henderson Mr. J. I.	Part lot 23 3890 777830
2.9.18	Long Street, Elsternwick	£650	Phillips Mr.	Murray A. A. Mrs.	Lot 190 3540 707829
2.8.18	Moama Rd. E. Malvern.	£600	Page Mrs. J.E.	Page Mrs. J. E.	Lot 30 3937 787230
28.6.18	Moodie St. Carnegie (24)	£570	Scudda Mrs. E.	Dawson Mr. C. W.	Part 20, " 21 3599 719727
30.11.18	35 Munster A. "	£600	Pitkin Miss H.	Dunkinson Mr. A.	3931 786001
2.8.18	Nott St. E. Malvern	£980	Potter Mrs. C.	Hasler Mr. J. W.	Lot 121 13941 788062
30.8.18	Princes Av. Caulfield.	£1384	Pearson Mrs. L.	Davis Misses.	Lot 12 2980 595889
18.7.18	Waverley Rd. E. Malvern		Turner Mrs. D.L.		Lot 15 2972 594341
22.5.19	Ash Grove, E. Malvern	£330	Palmer Mr. S.	Collins Mr. J. V.	1901 S.E. 2966 593120
23.9.19	Alice Street, Malvern. (9)	£650	Stewart Mr. R.L.	Edmunds Mr. W.P.	3812 762239
4.4.18	Balaclava Rd. Caulfield.	£830	Dobeli Mr. F.	Smitheran Mrs. R.	Lot 7 3802 760331
18.6.19	59 Brunel St. E. Malvern	£800	Winks Mrs. A.	McDonald Mr. E. H.	Lot 107 3981 796086
15.4.19	"Emo" Brunel St. E. Malvern	£670	Stephens Mr. G.	Bawden Mrs. L.	Lot 114 4124 824630
4.1.19	"Ballara" Clarence St. Elsternwick.	£666	Reid Mr. A. L.	Wain Mr. T. V.	3874 774757
24.4.19	Darling Rd. E. Malvern.	£450	O'Brien Mr. E.C.	Hyalop Mr. D.	Lots 13, 14, 15 2835 566979
20.1.19	"Valmai," Repton Rd. E. Mal.	£410	Wilson Mr. C. i.	Phelan Mrs. E.	3834 766641

Estate Agents ledger (GEHS Collection)



## A link to the history of North Road Medical, featured in our November 2023 newsletter.

It was with much interest that I read, in the November newsletter, the article on Bruce Hallows and the North Road Medical Centre. Bruce's sister, Gladys ("Glad") was my mother's Doctor and it was she who delivered me at Windarra Private Hospital, Williams Road, Toorak, in 1951! My mother had little need of a doctor until some ten years later, when she developed pernicious anaemia, and my father called Glad into service once again. My mother needed fortnightly injections of Cytamen (Vitamin B) and Glad would come to our home in Hampton, boil up the syringe in a saucepan on the stove, and give the injection. Glad had rather a limp, perhaps due to congenital hip dislocation, and she was a tall woman, so I can still see and hear her arriving with her Gladstone bag full of notes, stethoscopes and the like, which she deposited on the kitchen table. I seem to remember a particular antiseptic kind of smell about her, not unpleasant, but quite distinctive. How times have changed!

Even as a young person I was interested in anything medical so I asked her many questions, which she always obligingly answered, and she showed a real interest when I decided to study to be a Medical Record Librarian (we're called Health Information Managers these days) after I left school.

I still have the original bill for Professional Attendance when I was born, for the sum of 11 pounds, 18 shillings and sixpence (see below). My father kept everything and I seem to have followed in his footsteps!

**Sal Joyce, GEHS Volunteer and Member**

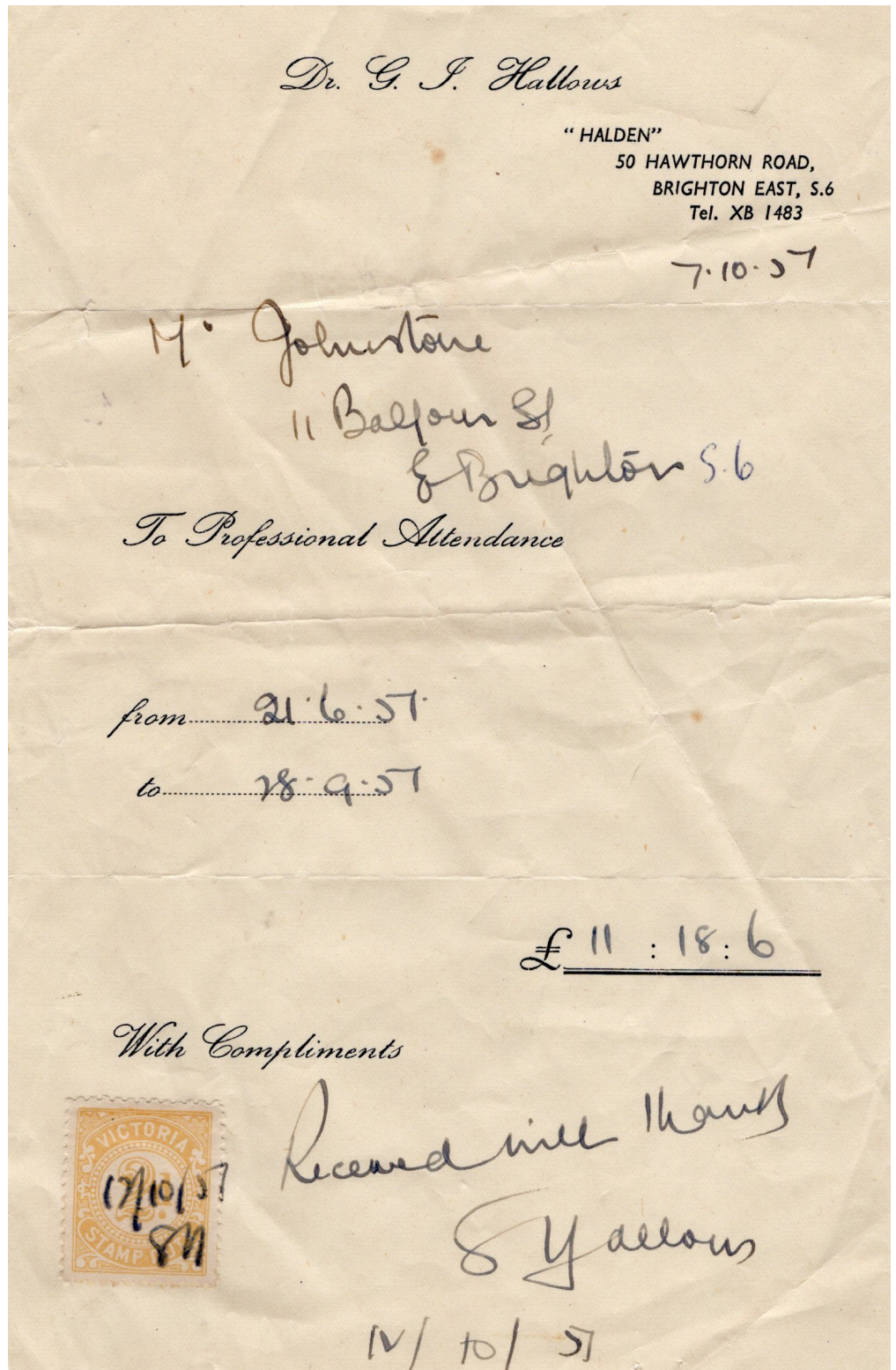



## Heatherbrae, A Caulfield mansion - November 2023 Speaker Series Report

On Wednesday 22<sup>nd</sup> November 2023 at the Murrumbeena Bowls Club with a 7.30pm commencement, local historian, Jenny O'Donnell, presented a talk on *Heatherbrae, A Caulfield Mansion*. This was to an audience of approximately 35 people, including the new owners of Heatherbrae, Julie and Vincent.

Jenny has the distinction of not only researching and publishing books on a number of Victorian mansions but also of being a foundation committee member of the Caulfield Historical Society. It was GEHS who encouraged her to research and write the history of Heatherbrae.

Jenny gave an overview of her research, including the origins of the original single storey building in the 1860s that was extended in the 1870s with a second storey and tower into its present appearance. A change of ownership in the 1920s was to see an interior with a hint of art deco opening up of space. This was displayed together with a number of the outstanding interior features such as the wunderlich ceilings, moulded fireplaces, floor tiles and leadlight door features, shown in a PowerPoint presentation. Jenny was able to highlight how these features made Heatherbrae such a distinctive example of the Victorian mansions that were so prominent in Caulfield at the end of the 19<sup>th</sup> Century.

Vincent and Julie then spoke of how they came to purchase Heatherbrae when it came on the market in 2022 (at a price the estate agents estimated would be in the vicinity of \$6 million). Of even more interest was their decision to restore the building. The old electrical wiring and plumbing had to be replaced and accompanying fittings modernised. In addition much of the termite affected wood was replaced and repainted. Vincent in a brief conversation at the end of the meeting advised me that the interior joists were made of Oregon.

The moulded ceilings, fireplaces and architraves need to be restored by specialist tradesmen. This is still a work in progress. Julie, with her interest in interior design, is doing much of the overseeing and matching the past with features needed for

modern home living. It is interesting to note that though the kitchen has been modernised the Fodera's will keep the large original wood fired stove.

This will be the Fodera's long-term home but the abundant space will lend itself to the promotion of art exhibitions as well as historical events. This building is something special for members of the Glen Eira Historical Society and the wider community.

At the end of her presentation Jenny was warmly thanked by President, Barbara Hoad who also advised that copies of Jenny's book *Heatherbrae A Caulfield Mansion* were available for sale. Copies of the book are also available from GEHS. All those in attendance were invited to partake in supper and have answered by Jenny and the Foderas any follow up questions. The night was also an opportunity for members and friends to catch up for some pre-Christmas chat - a most successful conclusion to the GEHS 2023 Speaker Series.

### Neville Daynes GEHS Volunteer/Member



Jenny O'Donnell signing her new book on Heatherbrae



## Heritage Matters

It turns out that there is always much activity in the planning and heritage world over the latter part of a year into January – the end of 2023 and start of 2024 is proof of the rule with much to report.

Regarding Structure Plans below for Elsternwick, Carnegie, Bentleigh and Glen Huntly, our concerns continue to include the impact of building heights and setbacks on the heritage, plus the impact of overshadowing at the winter solstice leading to less patronage of our wonderful heritage retail strips.

### Caulfield Racecourse

**Melbourne Racing Club's (MRC) new grandstand at Caulfield Racecourse:** Following Glen Eira Council's approval of the new Glasshouse at the eastern carpark site, Heritage Victoria approved Permit Application 37878 without changes to the MRC's plans for a new replacement stand ie. the Rupert Clarke Stand **will** be demolished to make way for the new stand. We are very disappointed with this outcome. It is now clear that even though the Heritage Council of Victoria (in their decision to add Caulfield Racecourse to the Victorian Heritage Register) recommended that the Conservation Management Plan (CMP) done by Lovell Chen be updated to reflect their findings and decision, this has not been done. What's more, there is no requirement for any such recommendation to be enforced. Therefore Heritage Permit Applications can use the original out-of-date CMP as one of the key documents for future changes to heritage

– not very satisfactory. Read the brief report at: <https://www.heritage.vic.gov.au/permits-and-approvals/recent-permit-decisions>

The MRC is also on record saying recently that it is seeking agreement from the Victorian Government for redevelopment of the old training facilities along Booran Road/Kambrook Road. That would be bad news for the historical Community Stables as well as impinging on the heritage-listed Lord Lodge and Tecoma properties.

**Caulfield Racecourse Reserve Trust's (CRRT) final Strategic Management Plan (SMP):** The CRRT's community consultation has now been factored into their final SMP. <https://www.crrt.org.au/wp-content/uploads/2023/12/CRRT-Strategic-Management-Plan-December-2023.pdf>

Their media release of 13/12/2023 indicates (along with other media reports) that the Melbourne Football Club is now a stakeholder for future uses of the Reserve – see <https://www.crrt.org.au/news/funding-approved-to-commence-planning-for-community-and-recreation-infrastructure-within-caulfield-racecourse-reserve/>

**Queens Avenue, QueenSAVEtrees Group:** local residents are campaigning to save the trees along the eastern boundary of the Racecourse along the nature strip. The trees do contribute to the vista of the Racecourse so we are supporting their campaign – see <https://www.facebook.com/groups/1963175397411007>

### Glen Huntly and Caulfield East Heritage Review (Planning Amendment C252glen) and C221glen Glen Huntly Major Activity Centre

At the 8/11/2023 Council meeting, Councillors unanimously approved starting the formal process with the Minister for Planning for Amendment C221. They also approved the inclusion of nine places/precincts from C252 to be moved to C221 as those places are within the Glen Huntly Activity Centre's boundary. Additionally they removed the old H0112 (Glen Huntly Railway Station) and H0113 (122 Grange Road – former Glen Huntly Post Office) as the former is now gone and the latter has been reassessed by an independent heritage consultant and found not to be of heritage significance – see Item 8.4 here <https://www.>



Caulfield Racecourse Main Entrance jostled by wall of new Mounting Yard, 16/12/2023 (GEHS Collection)



## Events and Exhibitions

### Speaker Series - Eyes on our Collection

We invite members and friends of Glen Eira Historical Society to join us and view close up some of the items in our Collection and hear their stories. Our volunteers have chosen particular objects they are interested in and will each give a short talk describing the item and its provenance.

7.30pm Wednesday 27th March 2024

Murrumbeena Bowls Club, 10 Blackwood Street, Carnegie VIC 3163

Bookings - <https://www.trybooking.com/CPUGP>

### Speaker Series - Author Talk, The Red Witch by Nathan Hobby

Join Nathan live via Zoom at Bentleigh library or online as he talks about his book on writer and activist Katharine Susannah Prichard including her connection to Glen Eira. Hosted by Glen Eira Historical Society.

12pm Wednesday 15th May 2024

Bookings - <https://library.gleneira.vic.gov.au/whats-on/events-calendar/author-talk-the-red-witch-with-nathan-hobby>

### Exhibition - Out of the Shadows, The Forgotten History of the War Widows Guild of Australia

By Zina Sofer (GEHS Volunteer/Member)

1 – 24 March 2024

Glen Eira City Council Gallery - Gallery Two

<https://www.gleneira.vic.gov.au/our-city/arts-and-culture/galleries-and-visual-art/exhibitions>

[gleneira.vic.gov.au/about-council/meetings-and-agendas/council-agendas-and-minutes/ordinary-council-meeting-wednesday-8-november-2023](https://www.gleneira.vic.gov.au/about-council/meetings-and-agendas/council-agendas-and-minutes/ordinary-council-meeting-wednesday-8-november-2023)

### Elsternwick Structure Plan - Amendment C256glen

At the Council meeting of 15/8/2023, the Elsternwick Structure Plan was approved by Councillors only after then Mayor Cr Magee used his second and deciding vote in favour ie it was hotly debated including in Public Questions. Councillors then, at Council meeting of 28/11/23, approved (by a split vote) this going forward as Amendment C256 to the Minister for Planning re

authorising public consultation. That exhibition period is likely to begin in mid-2024.

See <https://www.gleneira.vic.gov.au/about-council/meetings-and-agendas/council-agendas-and-minutes/ordinary-council-meeting-tuesday-28-november-2023>

### One of the key components of the Structure Plan was updated on 28/11/2023:

“The adopted Structure Plan also committed to downzone most of the residential properties in the activity centre study area that are within the heritage overlay from RGZ to NRZ, as well as downzoning a number of properties south of



Glen Huntly Road that are currently affected by the Neighbourhood Character Overlay Schedule 4 (NCO4). This component of the Structure Plan is proposed to be implemented through an upcoming planning scheme amendment which will consider the rezoning alongside heritage."

Councillors also noted again on 28/11/2023 that May Street West in Elsternwick is not a road at law within the meaning of the Road Management Act 2004. This resolved one of the outstanding VCAT Conditions for the Woolworths development in Selwyn Street Elsternwick, removing a further barrier for Woolworths to proceed.

### Caulfield North Heritage Review

GECC adopted (unanimously) the City of Glen Eira Caulfield North Heritage Review 2023 (Volumes 1 and 2) at Council meeting of 15/08/2023. <https://www.gleneira.vic.gov.au/services/planning-and-building/planning-for-the-future/heritage/heritage-studies> Scroll down to view the Heritage Studies including Caulfield North.

### Bentleigh East Neighbourhood Activity Centre Amendment C247glen, Carnegie Structure Plan Amendment C237glen & Bentleigh Structure Plan

At the 28/11/2023 Council meeting, Councillors noted community feedback and moved unanimously to request Minister for Planning to appoint an independent planning panel to consider all submissions for both these Amendments. The two independent panels are currently in progress, so we will leave these until next time.

The same meeting considered the Community Feedback Report for the **Bentleigh Structure Plan**, see again <https://www.gleneira.vic.gov.au/about-council/meetings-and-agendas/council-agendas-and-minutes/ordinary-council-meeting-tuesday-28-november-2023>

We would also like to acknowledge the sad passing of Cr David Zyngier who was a strong supporter of heritage along with many other grass-roots community issues. Our condolences to his family.

**Anne Kilpatrick, Secretary, February 2024**

**March 2024 Newsletter Editorial Team**  
Neville Daynes, Joy Mawbey, Barbara Hoad

**GLEN EIRA HISTORICAL SOCIETY COMMITTEE**  
President / Treasurer - Barbara Hoad  
Secretary / Vice-President - Anne Kilpatrick Committee - Carol Mayell  
Committee meets monthly

**We thank David Southwick MP for printing this Newsletter.**

We acknowledge that the Boon Wurrung/Bunurong peoples of the Kulin Nation are the traditional owners and custodians of the area covered by the City of Glen Eira

Community Bank · Murrumbeena



GLEN EIRA  
CITY COUNCIL

**PROUDLY SUPPORTED BY**  
Glen Eira City Council Community Grants  
and Bendigo Bank Murrumbeena

Address: 965 Glen Huntly Rd Caulfield 3162  
Call: (03) 9077 5395 | Email: [gehs@optusnet.com.au](mailto:gehs@optusnet.com.au)

Opening Hours: Open on Tuesdays 9am - 1pm (appointments preferred).  
Appointments at other times may be arranged.

ABN: 11 335 469 474, A0041700U

Visit our Website: <https://www.gehs.org.au>